



CONECTORES

Strokmatic
Automation Technology

SKC

Conector Recto con Hexágono Interno

Como Ordenar:

⊙SKC

Serie SKC

⊙ Conector Recto con Hexágono Interno.

⊙06 -

⊙D

4mm 04
6mm 06
8mm 08
10mm 10
12mm 12
14mm 14
16mm 16

⊙03

R

1/8" 01
1/4" 02
3/8" 03
1/2" 04

∅ Manguera

mm

Rosca PT

M5 1/8" 1/4" 3/8" 1/2"

∅ 4

∅ 6

∅ 8

∅ 10

∅ 12

∅ 14

∅ 16

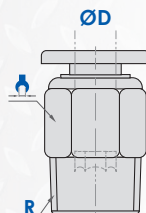

SKCF

Conector Recto con Rosca Hembra

Como Ordenar:

⊙SKCF

Serie SKCF

⊙ Conector Recto con Rosca Hembra

⊙06 -

⊙D

4mm 04
6mm 06
8mm 08
10mm 10
12mm 12

⊙03

R

1/8" 01
1/4" 02
3/8" 03
1/2" 04

∅ Manguera

mm

Rosca PT

M5 1/8" 1/4" 3/8" 1/2"

∅ 4

∅ 6

∅ 8

∅ 10

∅ 12

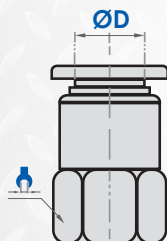

SKL

Conector Codo 90° Orientable

Como Ordenar:

SKL

Serie SKL

Conector Codo 90° Orientable

06 -

ØD

4mm 04
6mm 06
8mm 08
10mm 10
12mm 12
14mm 14
16mm 16

03

R

1/8" 01
1/4" 02
3/8" 03
1/2" 04

Ø Manguera

mm

Ø 4

Ø 6

Ø 8

Ø 10

Ø 12

Ø 14

Ø 16

Rosca PT

M5 1/8" 1/4" 3/8" 1/2"

Ø 4

Ø 6

Ø 8

Ø 10

Ø 12

Ø 14

Ø 16

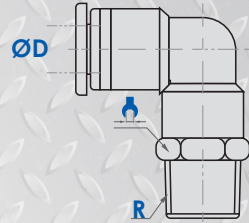

SKLL

Conector Codo 90° Orientable Extendido

Como Ordenar:

SKLL

Serie SKLL

Conector Codo 90° Orientable Extendido

06 -

ØD

4mm 04
6mm 06
8mm 08
10mm 10
12mm 12

03

R

1/8" 01
1/4" 02
3/8" 03
1/2" 04

Ø Manguera

mm

Ø 4

Ø 6

Ø 8

Ø 10

Ø 12

Rosca PT

M5 1/8" 1/4" 3/8" 1/2"

Ø 4

Ø 6

Ø 8

Ø 10

Ø 12

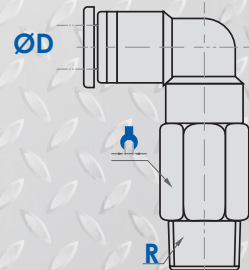

SKHF

Conector Codo 90° orientable compacto con rosca hembra superior

Como Ordenar:

SKHF

Serie SKHF

Conector codo 90° orientable compacto con rosca hembra superior

06

ØD

4mm 04
6mm 06
8mm 08
10mm 10
12mm 12

03

R

1/8" 01
1/4" 02
3/8" 03
1/2" 04

Ø Manguera

mm	M5	1/8"	1/4"	3/8"	1/2"
Ø 4	[Barra azul]				
Ø 6	[Barra azul]				
Ø 8	[Barra azul]				
Ø 10	[Barra azul]				
Ø 12	[Barra azul]				

Rosca PT



SKH

Conector Codo 90° orientable compacto

Como Ordenar:

SKH

Serie SKH

Conector en L 90° orientable compacto

06

ØD

4mm 04
6mm 06
8mm 08
10mm 10
12mm 12

03

R

1/8" 01
1/4" 02
3/8" 03
1/2" 04

Ø Manguera

mm	M5	1/8"	1/4"	3/8"	1/2"
Ø 4	[Barra azul]				
Ø 6	[Barra azul]				
Ø 8	[Barra azul]				
Ø 10	[Barra azul]				
Ø 12	[Barra azul]				

Rosca PT



SKLF

Conector Codo 90° orientable con rosca hembra

Como Ordenar:

SKLF

Serie SKLF

Conector codo 90° orientable con rosca hembra

ØD	06	-	03
4mm	04		R
6mm	06		1/8" 01
8mm	08		1/4" 02
10mm	10		3/8" 03
12mm	12		1/2" 04

Ø Manguera	Rosca PT				
mm	M5	1/8"	1/4"	3/8"	1/2"
Ø 4	[Barra azul]				
Ø 6	[Barra azul]				
Ø 8	[Barra azul]				
Ø 10	[Barra azul]				
Ø 12	[Barra azul]				

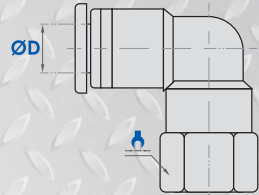
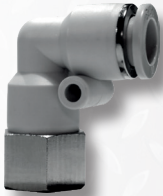

SKB

Conector en T roscable

Como Ordenar:

SKB

Serie SKB

Conector en T roscable

ØD	06	-	03
4mm	04		R
6mm	06		1/8" 01
8mm	08		1/4" 02
10mm	10		3/8" 03
12mm	12		1/2" 04

Ø Manguera	Rosca PT				
mm	M5	1/8"	1/4"	3/8"	1/2"
Ø 4	[Barra azul]				
Ø 6	[Barra azul]				
Ø 8	[Barra azul]				
Ø 10	[Barra azul]				
Ø 12	[Barra azul]				

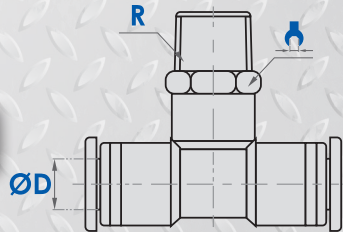

SKX Conector Y con rosca

Como Ordenar:

SKX

Serie SKX

Conector Y con rosca

06

ØD

4mm 04
6mm 06
8mm 08
10mm 10
12mm 12

03

R

1/8" 01
1/4" 02
3/8" 03
1/2" 04

Ø Manguera

Rosca PT

mm	M5	1/8"	1/4"	3/8"	1/2"
Ø 6					
Ø 8					
Ø 10					
Ø 12					

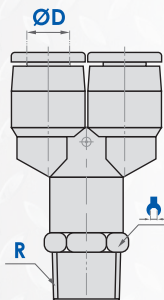

SKU Cople Recto

Modelo	Tubo Ø mm
SKU04	4
SKU06	6
SKU08	8
SKU10	10
SKU12	12
SKU16	16

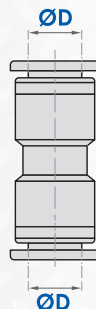
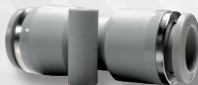

SKV Cople Codo 90°

Modelo	Tubo Ø mm
SKV04	4
SKV06	6
SKV08	8
SKV10	10
SKV12	12

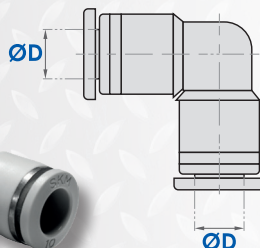

SKE

Cople en T

Modelo	Tubo Ø mm
SKE04	4
SKE06	6
SKE08	8
SKE10	10
SKE12	12
SKE16	16

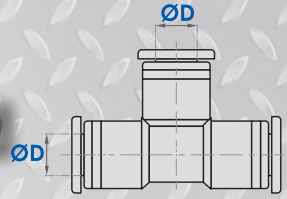

SKY

Cople en Y

Modelo	Tubo Ø mm
SKY04	4
SKY06	6
SKY08	8
SKY10	10
SKY12	12

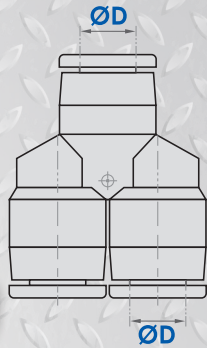

SKG

Reducción Recta

Modelo	Tubo DØ mm	Tubo dØ mm
SKG06-04	6	4
SKG08-06	8	6
SKG10-08	10	8
SKG12-10	12	10

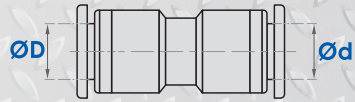

SKGJ

Reducción Recta tipo Plug

Modelo	Tubo DØ mm	Tubo dØ mm
SKGJ06-04	6	4
SKGJ08-06	8	6
SKGJ10-06	10	6
SKGJ10-08	10	8
SKGJ12-08	12	8
SKGJ12-10	12	10

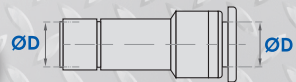

SKW Reducción Y

Modelo	Tubo DØ mm	Tubo dØ mm
SKW06-4	6	4
SKW08-6	8	6
SKW10-8	10	8
SKW12-10	12	10

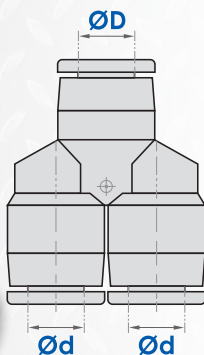

SKEG Reducción en T

Modelo	Tubo DØ mm	Tubo dØ mm
SKEG06-4	6	4
SKEG08-6	8	6
SKEG10-08	10	8
SKEG12-10	12	10

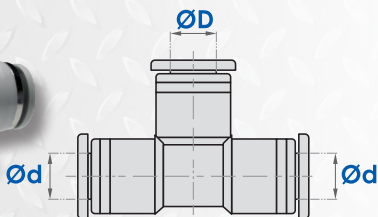

SKK Conector Triple

Modelo	Tubo Ø mm
SKK04	4
SKK06	6
SKK08	8
SKK10	10
SKK12	12

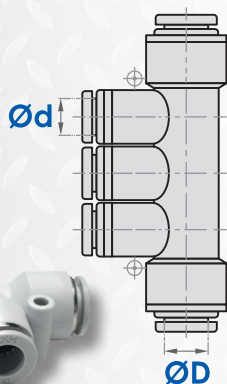

SKZ

Conector múltiple en X

Modelo	Tubo Ø mm
SKZ04	4
SKZ06	6
SKZ08	8
SKZ10	10
SKZ12	12

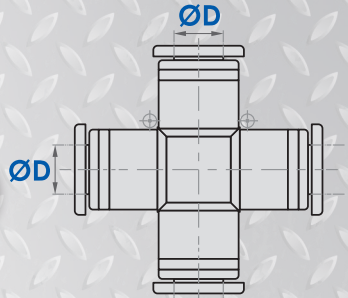

SKM

Conector Pasamuro

Modelo	Tubo Ø mm	Cuerda
SKM04	4	M12x1
SKM06	6	M14x1
SKM08	8	M16x1
SKM10	10	M18x1
SKM12	12	M20x1

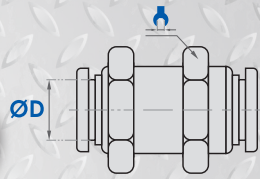

SKLM

Conector Pasamuro en Codo

Modelo	Tubo Ø mm	Cuerda
SKLM04-M12	4	M12x1
SKLM06-M14	6	M14x1
SKLM08-M16	8	M16x1
SKLM10-M18	10	M18x1
SKLM12-M20	12	M20x1

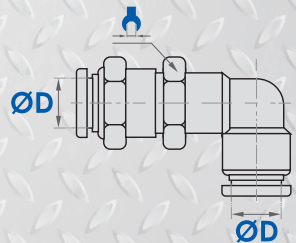

SPP

Tapón tipo Plug

Modelo	Tubo Ø mm
SPP04	4
SPP06	6
SPP08	8
SPP10	10
SPP12	12

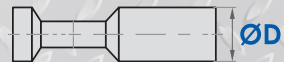

SKMF

Conector Pasamuro con rosca hembra

Como Ordenar:

SKMF

Serie SKMF

Conector Y con rosca

06

ØD

4mm 04
6mm 06
8mm 08
10mm 10
12mm 12

03

R

1/8" 01
1/4" 02
3/8" 03
1/2" 04



Ø Manguera mm	Rosca PT				
	M5	1/8"	1/4"	3/8"	1/2"
Ø 4	[Bar chart showing length for Ø 4]				
Ø 6	[Bar chart showing length for Ø 6]				
Ø 8	[Bar chart showing length for Ø 8]				
Ø 10	[Bar chart showing length for Ø 10]				
Ø 12	[Bar chart showing length for Ø 12]				

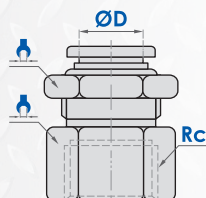

SRC

Regulador de Flujo (mm)

Como Ordenar:

SRC

Serie SRC

Conector Y con rosca

06

ØD

4mm 04
6mm 06
8mm 08
10mm 10
12mm 12

03

R

1/8" 01
1/4" 02
3/8" 03
1/2" 04



Ø Manguera mm	Rosca PT				
	M5	1/8"	1/4"	3/8"	1/2"
Ø 4	[Bar chart showing length for Ø 4]				
Ø 6	[Bar chart showing length for Ø 6]				
Ø 8	[Bar chart showing length for Ø 8]				
Ø 10	[Bar chart showing length for Ø 10]				
Ø 12	[Bar chart showing length for Ø 12]				

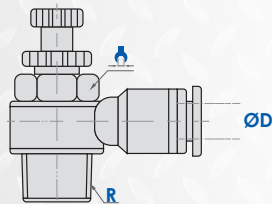

RFSA

Regulador de Flujo en Línea con check

Modelo	Tubo Ø mm
RFSA04	4
RFSA06	6
RFSA08	8
RFSA10	10
RFSA12	12

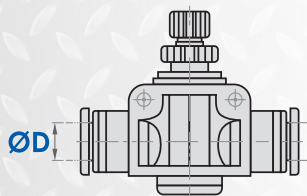

RFL

Regulador de flujo metálico roscado con check

Modelo	Tubo Ø mm	Rosca
RFL01-01	1/8	1/8
RFL02-02	1/4	1/4
RFL03-03	3/8	3/8
RFL04-04	1/2	1/2



IBP

Tapón roscado

Modelo	Rosca Pulg.
IBP-01	1/8
IBP-02	1/4
IBP-03	3/8
IBP-04	1/2



SKVFF

Válvula 2/2 manual con conector

Modelo	Tubo DØ mm	Tubo dØ mm
SKVFF06-4	4	4
SKVFF08-6	6	6
SKVFF10-08	8	8
SKVFF12-10	10	10

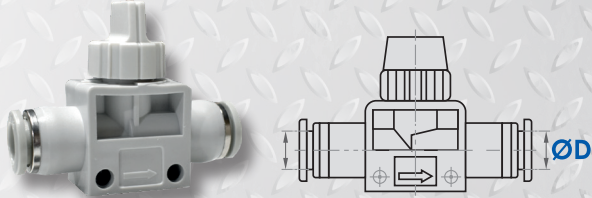

SBM

Silenciador Plano de bronce

Modelo	Rosca PT
SBM-01	1/8"
SBM-02	1/4"
SBM-03	3/8"
SBM-04	1/2"
SBM-06	3/4"



SB

Silenciador plano de bronce

Modelo	Rosca PT
SB-M5	M5
SB-01	1/8"
SB-02	1/4"
SB-03	3/8"
SB-04	1/2"
SB-06	3/4"
SB-10	1"
SB-12	1 1/4"
SB-14	1 1/2"
SB-20	2"

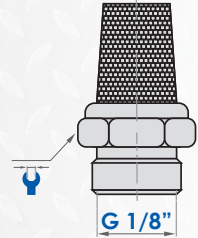

SFC

Silenciador de bronce regulable

Modelo	Rosca PT
SFC-01	1/8"
SFC-02	1/4"
SFC-03	3/8"
SFC-04	1/2"
SFC-06	3/4"

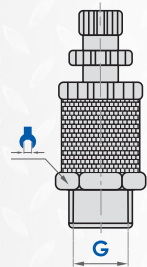

PSU

Silenciador de Plástico

Modelo	Rosca PT
PSU-01	1/8"
PSU-02	1/4"
PSU-03	3/8"
PSU-04	1/2"

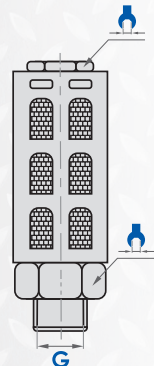

Tubo Poliuretano

Modelo	PU-0425 TRBU	PU-0604 TRBU	PU-0855 TRBU	PU-1070 TRBU
Tubo Ø mm	4	6	8	10
Longitud de Rollo m	100			

Modelo	PU-1208 TRBU	PU-1410 CB	PU-1612 TRBU
Tubo Ø mm	12	14	16
Longitud de Rollo m	100		

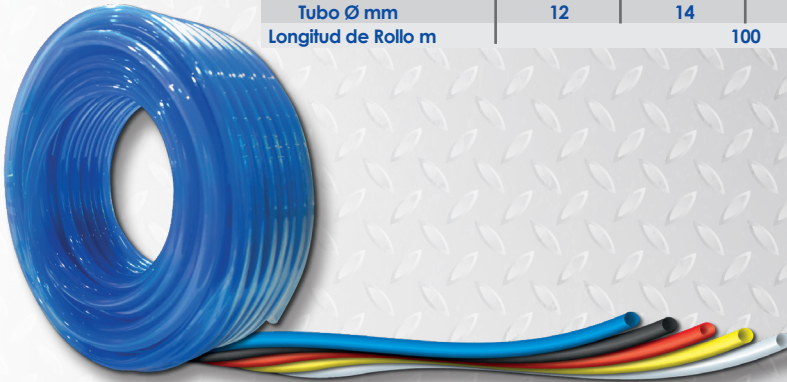

Poliuretano Helicoidal Sin Conector



Como Ordenar:

<ul style="list-style-type: none"> ○ PUR ○ PUR Manguera Helicoidal 	<ul style="list-style-type: none"> ○ 08 ○ 08 08mm ○ 10 10mm ○ 12 12mm ○ 14 14mm ○ 16 16mm 	<ul style="list-style-type: none"> ○ 05 ○ Longitud ○ 05 5m ○ 10 10m ○ 15 15m ○ 20 20m ○ 25 25m 	<ul style="list-style-type: none"> ○ CBU ○ Color ○ CBU Azul Traslúcido ○ BU Azul Solido
--	---	---	---

*Otros Colores Preguntar al Asesor **Sin Conector

Poliuretano Helicoidal

Con Conector
(Hasta 10m máx)

Modelo	Tubo Ø mm
--------	--------------

Azul	PUR106510BU	10
------	-------------	----

Naranja	PUR106510RU	10
---------	-------------	----



T-Cut

Cortador de Manguera

Para diámetros de manguera desde 4mm hasta 16 mm, 1/8" hasta 1/2" externo.



IAG-BU

Pistola de Sopleteo

Con extensión de aluminio para llegar a lugares estrechos

Modelo	Rosca Hembra
--------	-----------------

IAG-BU	1/4"
--------	------



K-610

Pistola de Sopleteo

Modelo	Rosca Macho
--------	----------------

K-610	1/4"
-------	------



SKC

Conector Recto con Hexágono Interno

Como Ordenar:

SKC

Serie SKC

Conector Recto con Hexágono Interno.

3/8" -

ØD

1/8" 1/8"

1/4" 1/4"

3/8" 3/8"

1/2" 1/2"

N03

R

1/16 1/16

1/8" N01

1/4" N02

3/8" N03

1/2" N04

Ø Manguera mm	Rosca PT			
	M5	1/8"	1/4"	3/8" 1/2"
Ø 1/8"				
Ø 1/4"				
Ø 3/8"				
Ø 1/2"				

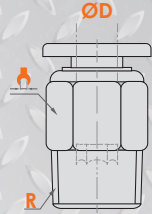
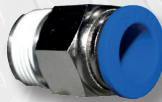

SKL

Conector Codo 90° Orientable

Como Ordenar:

SKL

Serie SKL

Conector Codo 90° Orientable

3/8" -

ØD

1/4" 1/4"

3/8" 3/8"

1/2" 1/2"

N03

R

1/8" N01

1/4" N02

3/8" N03

1/2" N04

Ø Manguera mm	Rosca PT			
	1/8"	1/4"	3/8"	1/2"
Ø 1/8"				
Ø 1/4"				
Ø 3/8"				
Ø 1/2"				

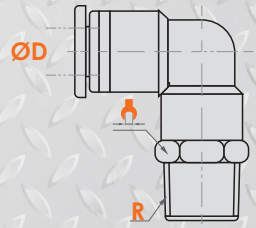
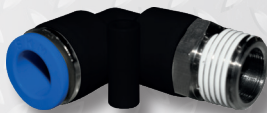

SKB

Conector en T roscable

Como Ordenar:

SKB

Serie SKB

Conector en T roscable

3/8" -

ØD

1/4" 1/4"
3/8" 3/8"
1/2" 1/2"

N03

R

1/8" N01
1/4" N02
3/8" N03
1/2" N04

Ø Manguera

Rosca PT

mm	1/8"	1/4"	3/8"	1/2"
Ø 1/4"	[Barra de color naranja]			
Ø 3/8"	[Barra de color naranja]			
Ø 1/2"	[Barra de color naranja]			

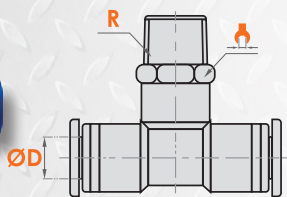

SKU

Cople Recto

Modelo	Tubo Ø Pul.
SKU1/4	1/4
SKU3/8	3/8
SKU1/2	1/2

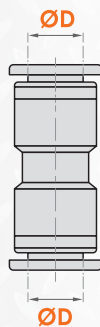

SKV

Cople Codo 90°

Modelo	Tubo Ø Pul.
SKV1/4	1/4
SKV3/8	3/8
SKV1/2	1/2

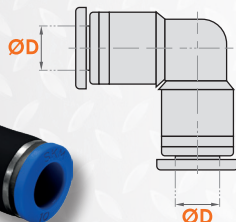
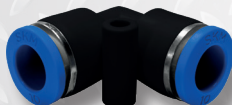

SKE

Cople en T

Modelo	Tubo Ø Pul.
SKE1/4	1/4
SKE3/8	3/8
SKE1/2	1/2



SKY

Cople en Y

Modelo	Tubo Ø Pul.
SKY1/4	1/4
SKY3/8	3/8
SKY1/2	1/2



SKG

Reducción Recta

Modelo	Tubo ØD Pul.	Tubo ØD Pul.
SKG1/4	3/8	1/4
SKG3/8	1/2	1/4
SKG1/2	1/2	3/8

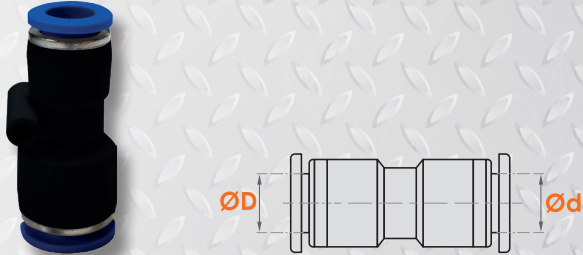

SRC Regulador de Flujo (mm)

Como Ordenar:

◉ SRC

Serie SRC

◉ Conector Y con rosca

◉ 3/8" -

ØD

1/4" 1/4"

3/8" 3/8"

1/2" 1/2"

◉ N03

R

1/8" N01

1/4" N02

3/8" N03

1/2" N04



Ø Manguera mm	Rosca PT				
	M5	1/8"	1/4"	3/8"	1/2"
Ø 4					
Ø 6					
Ø 8					
Ø 10					
Ø 12					

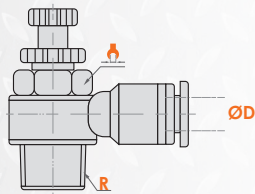

Tubo Poliuretano

Modelo	PU-1/8" BU	PU-1/4" BU	PU-3/8" BU	PU-1/2" BU
Tubo Ø mm	1/8"	1/4"	3/8"	1/2"
Longitud de Rollo m	200		100	

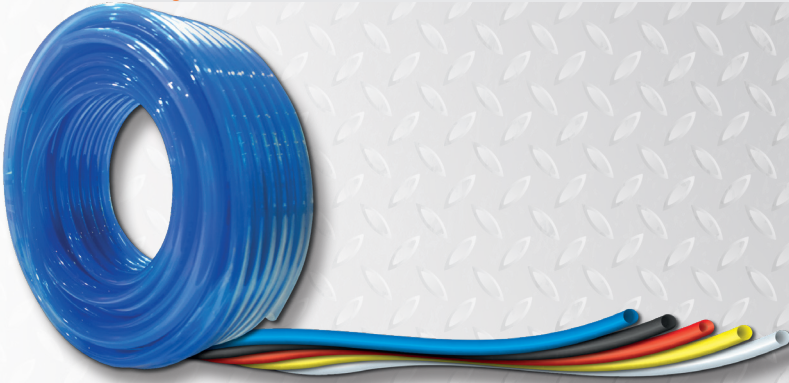

Poliuretano Helicoidal Sin Conector



Como Ordenar:

<ul style="list-style-type: none"> ⊙ PUR ⊙ PUR Manguera Helicoidal 	<ul style="list-style-type: none"> ⊙ 08 ⊙ 05 	<ul style="list-style-type: none"> ⊙ Longitud ⊙ CBU
<ul style="list-style-type: none"> Diámetro 1/4 1/4" 1/8 1/8" 3/8 3/8" 1/2 1/2" 	<ul style="list-style-type: none"> 05 5m 10 10m 15 15m 20 20m 25 25m 	<ul style="list-style-type: none"> Color ⊙ CBU Azul Traslúcido BU Azul Solido

*Otros Colores Preguntar al Asesor

**Sin Conector

SKCT

Conector Recto con Hexágono Interno

Como Ordenar:

SKCT

Serie SKCT

Conector Recto con Hexágono Interno.

06

ØD

4mm 04
6mm 06
8mm 08
10mm 10
12mm 12

03

R

1/8" 01
1/4" 02
3/8" 03
1/2" 04

Ø Manguera

mm	M5	1/8"	1/4"	3/8"	1/2"
Ø 4					
Ø 6					
Ø 8					
Ø 10					
Ø 12					
Ø 14					
Ø 16					

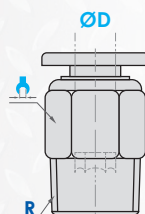

SKLT

Conector Codo 90° Orientable

Como Ordenar:

SKLT

Serie SKLT

Conector Codo 90° Orientable

06

ØD

4mm 04
6mm 06
8mm 08
10mm 10
12mm 12

03

R

1/8" 01
1/4" 02
3/8" 03
1/2" 04

Ø Manguera

mm	M5	1/8"	1/4"	3/8"	1/2"
Ø 4					
Ø 6					
Ø 8					
Ø 10					
Ø 12					
Ø 14					
Ø 16					

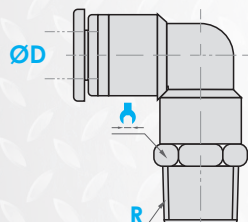
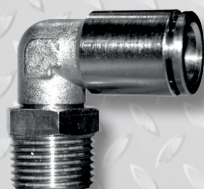

SKBT Conector en T roscable

Como Ordenar:

Ø Manguera	Rosca PT				
mm	M5	1/8"	1/4"	3/8"	1/2"
Ø 4					
Ø 6					
Ø 8					
Ø 10					
Ø 12					

SKBT

Serie SKBT

Conector en T roscable

06 - 03

ØD

R

4mm	04	1/8"	01
6mm	06	1/4"	02
8mm	08	3/8"	03
10mm	10	1/2"	04
12mm	12		

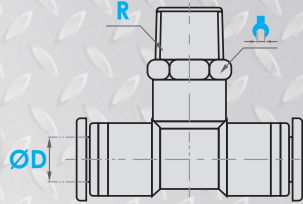

SKUT Cople Recto

Modelo Igual	Tubo Ø mm
SKUT-04	4
SKUT-06	6
SKUT-08	8
SKUT-10	10
SKUT-12	12

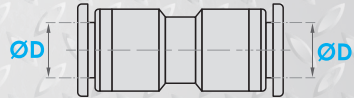

SKET Cople en T

Modelo	Tubo Ø mm
SKET-04	4
SKET-06	6
SKET-08	8
SKET-10	10
SKET-12	12

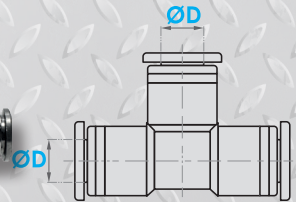
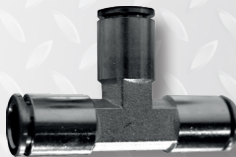

ROMIHN[®]
Automation Technology

Strokmatic[®]
Automation Technology

www.romihn.com.mx

222 940 0313

contactcenter@romihn.com.mx

Ubicaciones

 Puebla	222 531 2925
 CDMX	553 408 1489
 Guadalajara	332 870 3192
 Querétaro	442 668 1414
 Tijuana	664 275 4360
 Santa Catarina	812 254 5561
 Aguascalientes	449 205 4364